

Eclipse 2.2

For flush wooden doors

Concealed hinge for internal flush doors with modern design. Eclipse 2.2 offers wide adjustments on three axis. The sash movement is fluid and precise up to 180°. Covers hide the adjustment screws and keep the door design even when the sash is open. Eclipse 2.2 stands out for high loading capacity, up to 60 kg with 2 hinges.



Up to 60 kg with two hinges,
80 kg with three hinges.



19 mm
max. extension.



For wood
doors.



Three adjustments
completely
independent.



Covers with
coverplate.

Hinge dimensions

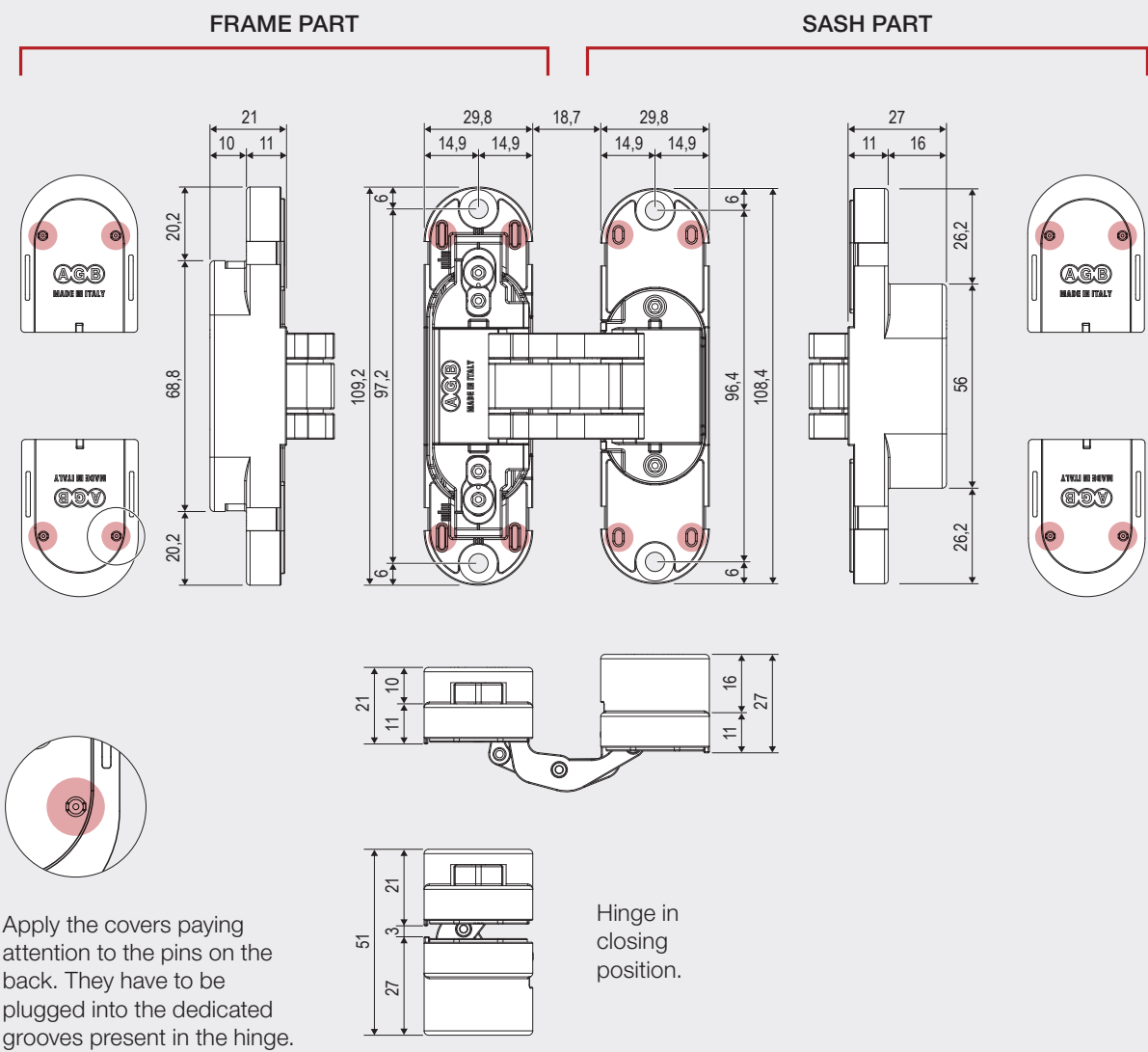

Hinge application

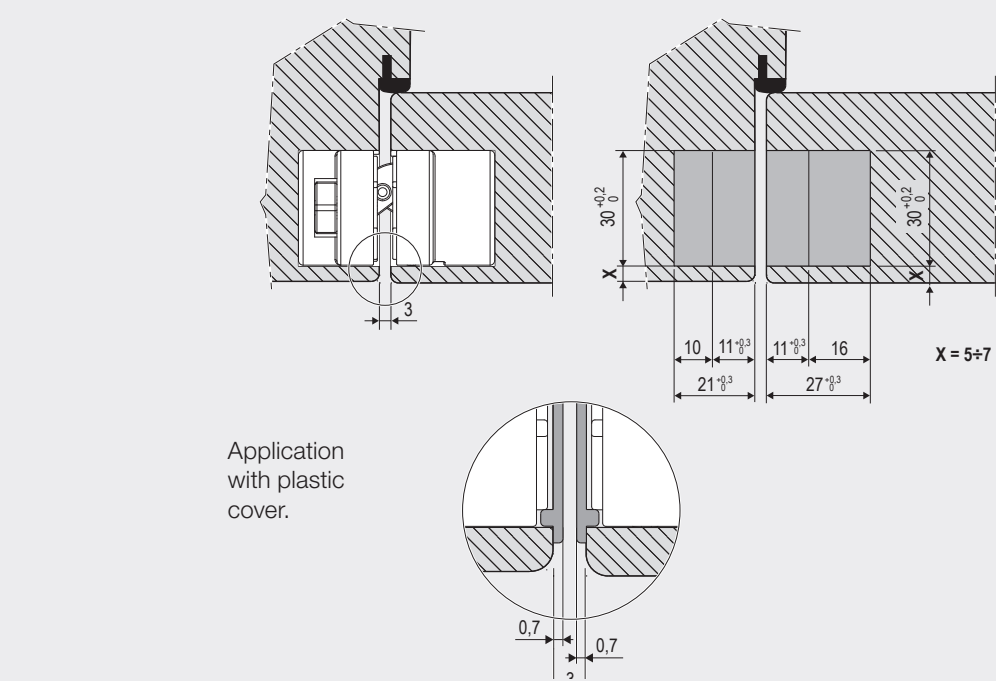

Drilling diagram

FRAME PART

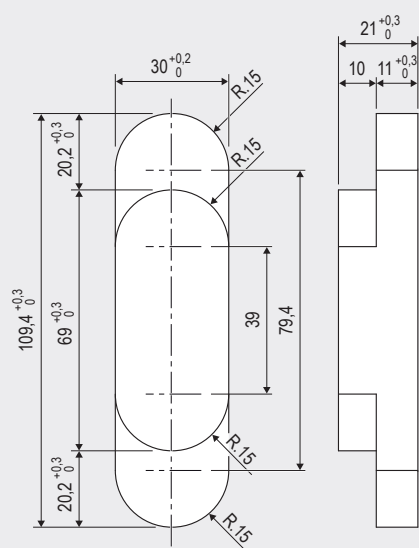

SASH PART

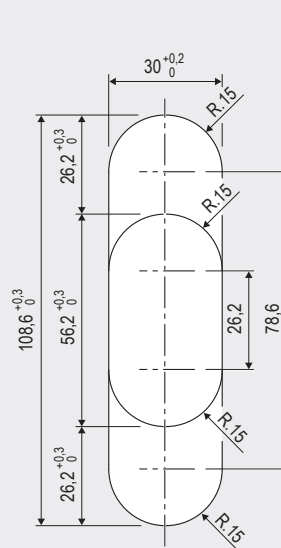

Hinge adjustments

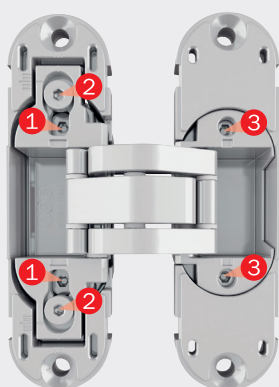

Please adjust the hinges with a 3 mm Allen key, as indicated here below:

- **±1 mm pressure adjustment:**
loosen the screws ❶ and move the hinge body.
After this operation fasten the screws.
- **±2 mm vertical adjustment:**
loosen the screws ❷ using a screwdriver or a wedge which is suitable for Eclipse hinges, art. E30200.89.01.
After this operation fasten the screws.
- **±1,5 mm horizontal adjustment:**
move the screws ❸.

Finishes

- 03. Brass plated PVD
- 06. Nickel plated PVD
- 22. Enamelled bronze plated
- 34. Matt chromium plated

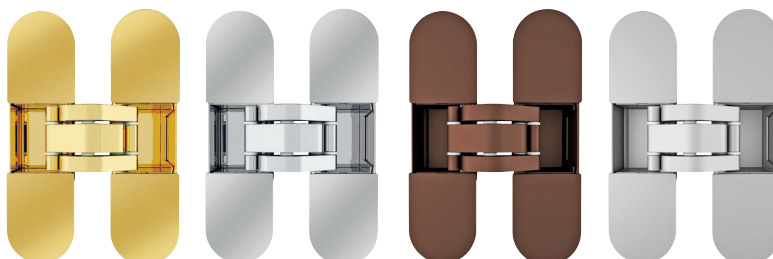

- 42. Light bronze plated
- 91. White
- 93. Matt black



Hinges application fields

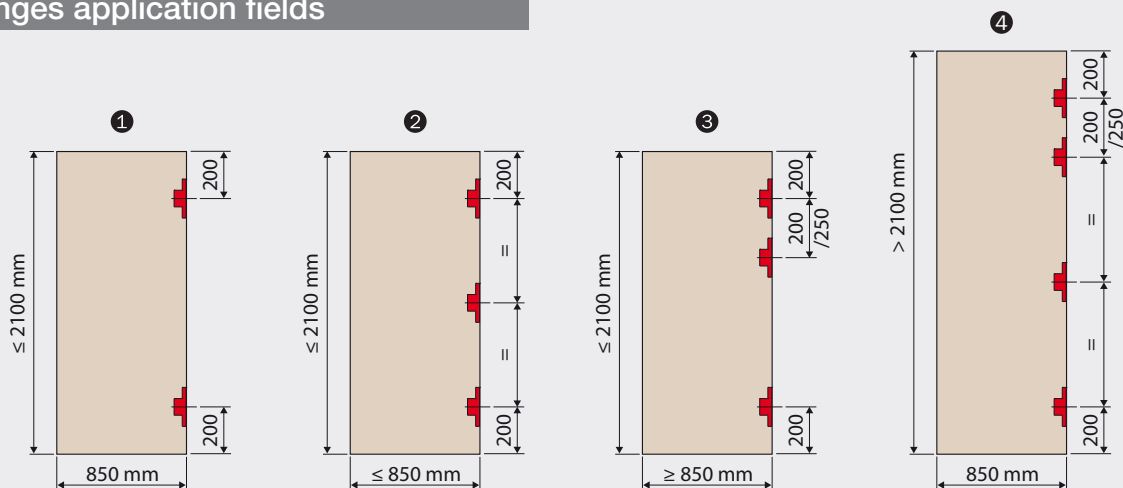

- ① Two hinges capacity is 60 kg. In any case if the door is higher than 1600 mm we suggest you a third hinge in the central position to reduce deformations.
- ② Three hinges capacity is 80 kg.
- ③ Three hinges capacity is 80 kg. The third hinge paired at the top is recommended when using an overhead door closer (A) or if installed in high-traffic locations.
- ④ The fourth hinge is recommended when using an overhead door closer (A) and door seals (B).

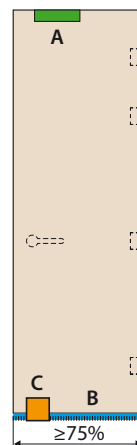

THIRD-PARTY ACCESSORIES



Overhead door closer (A)

Door seals (B)

Floor-mounted door stop (C)

Install it at a distance from the hinges of at least 75 % of the sash width in the direction of the lock.

Tests carried out with softwood and fixing of the hinge with screws as per technical data sheet*

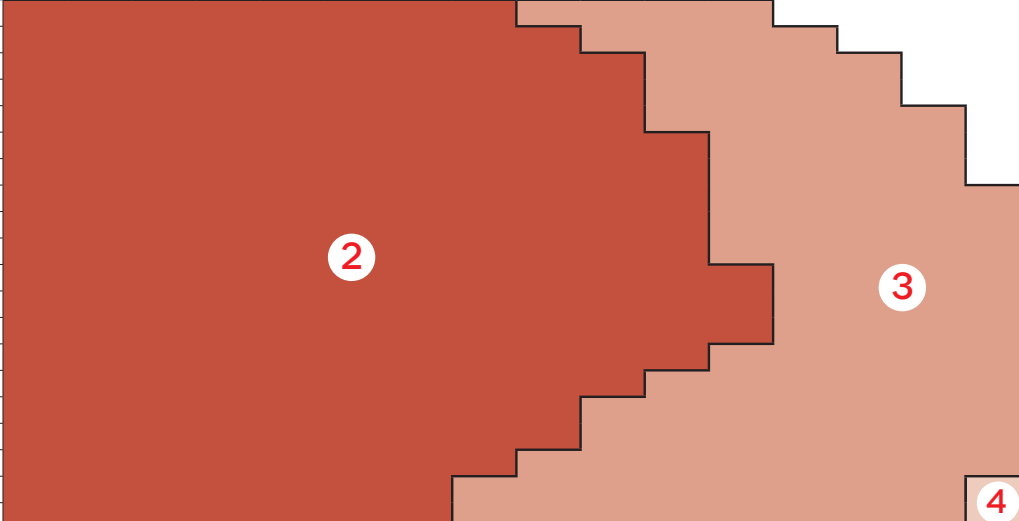
																
	300	400	500	600	650	700	750	800	850	900	950	1000	1050	1100	1150	1200
600																
700																
800																
900																
1000																
1100																
1200																
1300																
1400																
1500																
1600																
1700																
1800																
1900																
2000																
2100																
2200																
2300																
2400																
2500																
2600																
2700																
2800																

* The technical sheets are available at www.agb.it.
Doors with specific gravity of 25 kg/m².