

Eclipse 5.0

High loading capacity hinges for flush doors

New high-capacity concealed hinge, designed for flush doors with heavy sashes and for hotel doors. Thanks to the three micrometric and independent adjustments, Eclipse 5.0 makes it easy to adjust even on very heavy doors. The screw-fixed metal covers ensure a precise and long-lasting fit.



Eclipse 5.0



Up to 100 kg with two hinges, 130 kg with three hinges.



Three micrometric and separate adjustments. Simple management of heavy sash.



Perfect together with door closer or door stopper.



Flush steel covers.

Hinge dimensions

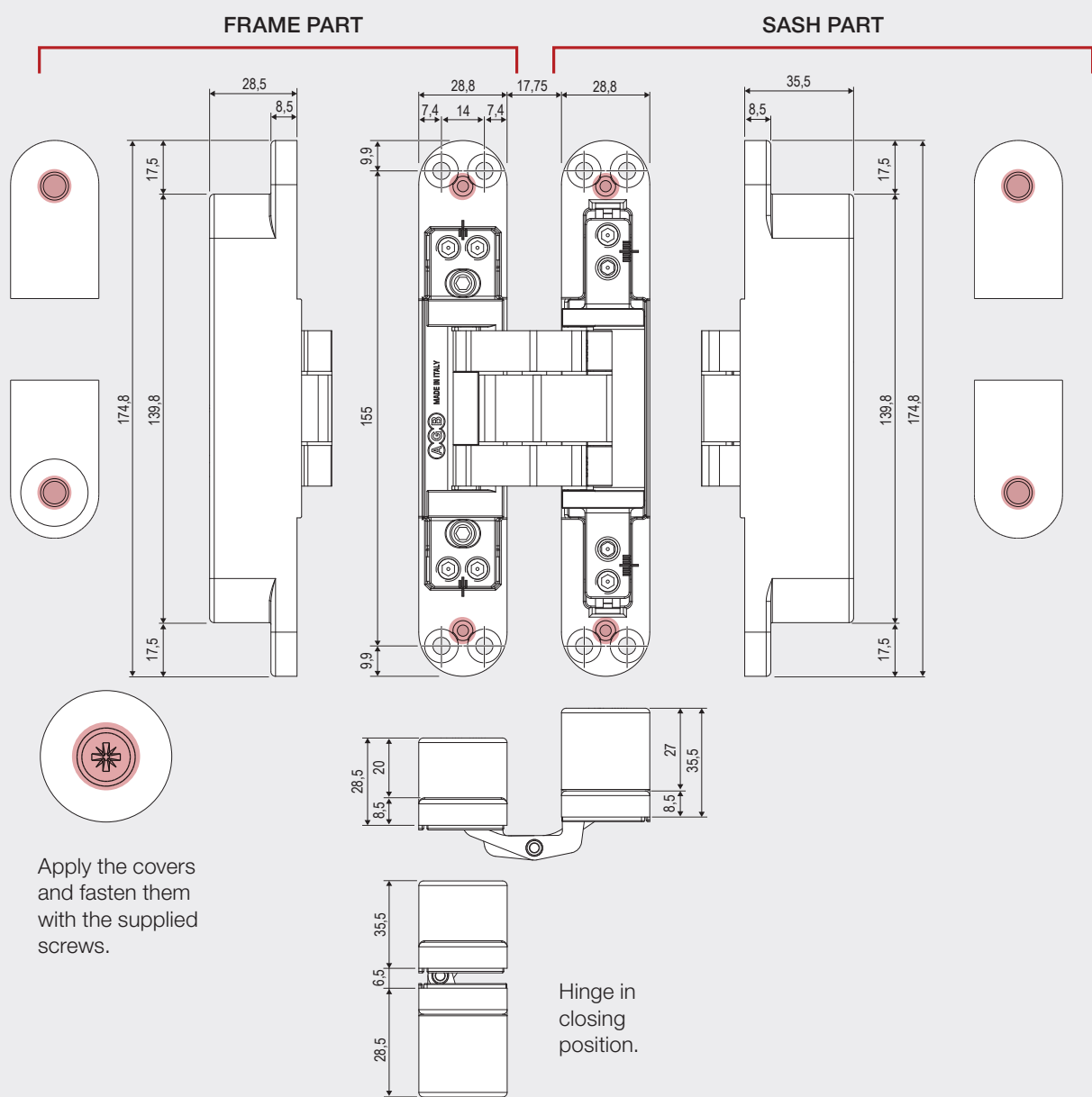

Hinge application

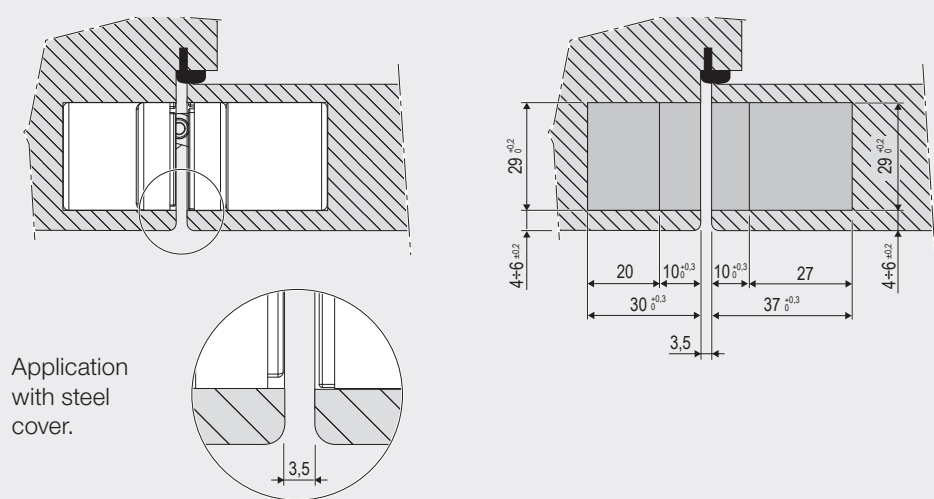

Drilling diagram

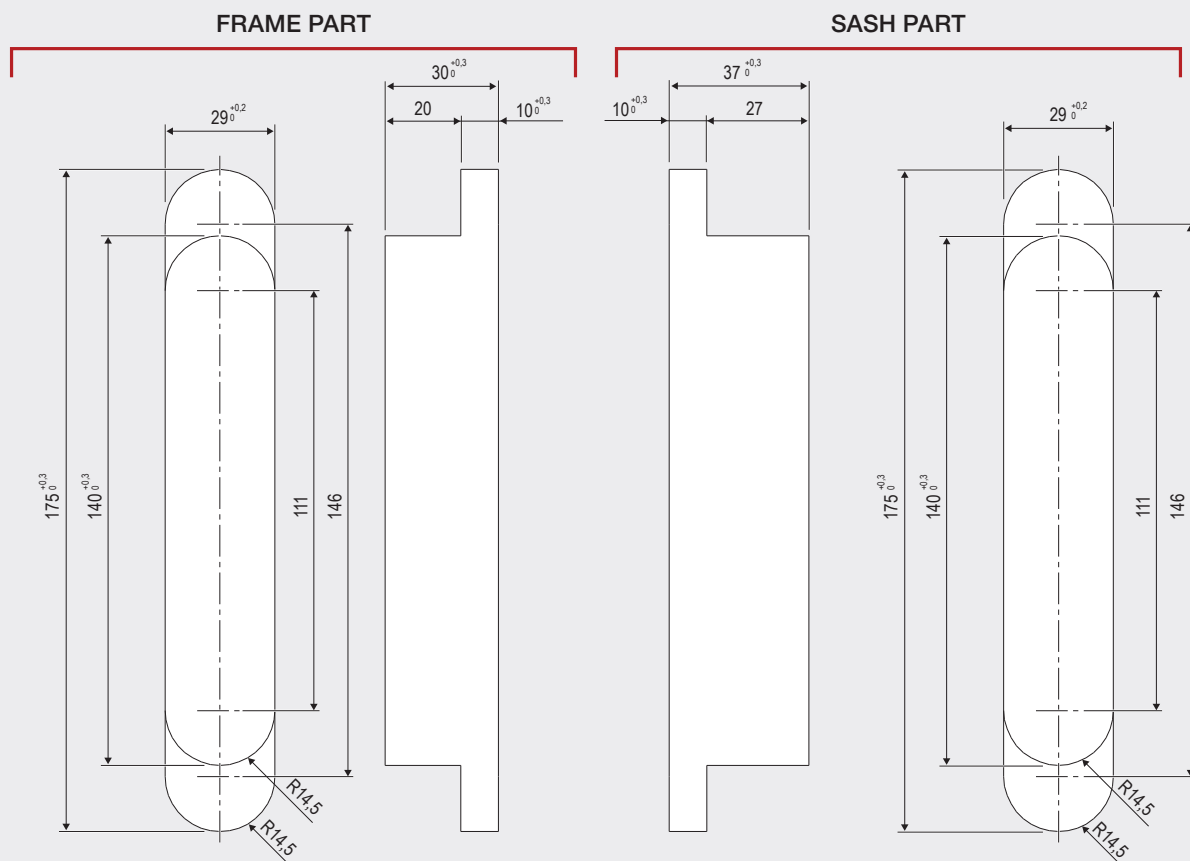

Hinge adjustments

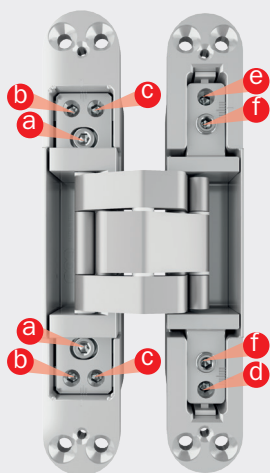

Please adjust the hinges one by one with a 4 mm Allen key; reach the desired adjustment on two screws alternatively and with little movements.

• ± 1 mm pressure adjustment:

PRESSURE INCREASE:

loosen **a**; screw **b** and unscrew **c**; fasten **a**.

PRESSURE DECREASED:

loosen **a**; unscrew **b** and screw **c**; fasten **a**.

• ± 3 mm vertical adjustment:

loosen **d**; raise (screw) or lower (unscrew) **e**; fasten **d**.

• ± 3 mm horizontal adjustment:

increase (unscrew) or decrease (screw) **i**.

Finishes

- 03. Brass plated PVD
- 06. Nickel plated PVD
- 22. Enamelled bronze plated
- 34. Matt chromium plated
- 42. Light bronze plated
- 91. White
- 93. Matt black

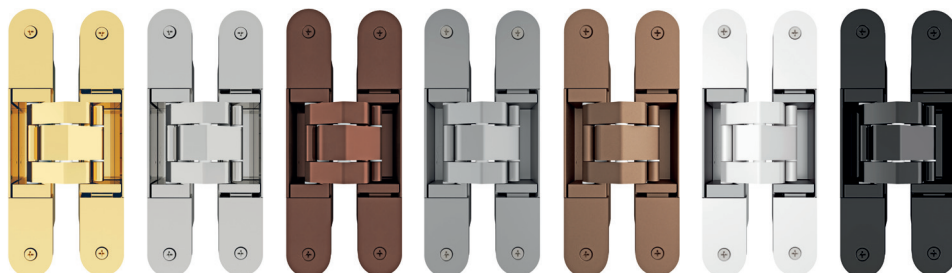

Hinges application fields

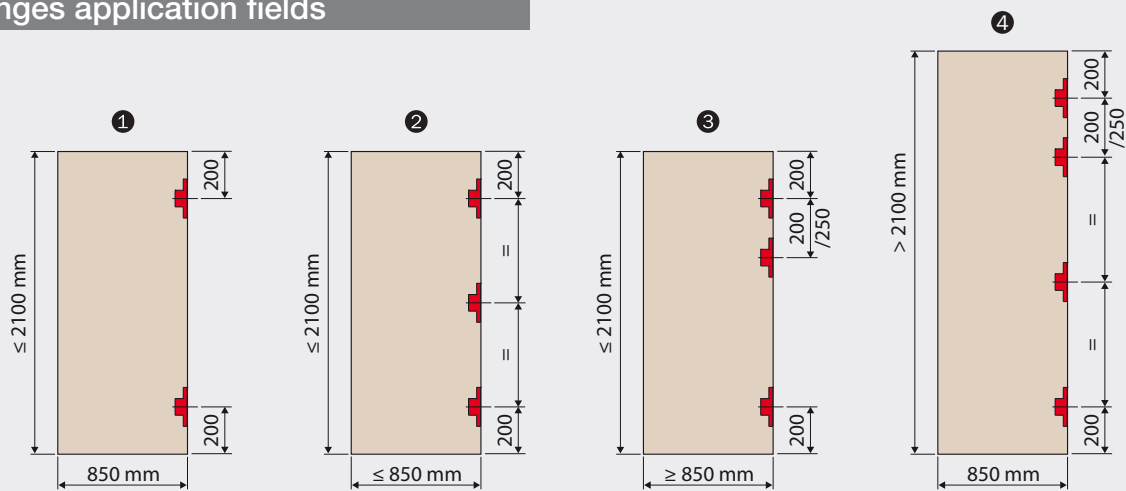

- 1 Two hinges capacity is 100 kg. In any case if the door is higher than 1600 mm we suggest you a third hinge in the central position to reduce deformations.
- 2 Three hinges capacity is 130 kg.
- 3 Three hinges capacity is 130 kg. The third hinge paired at the top is recommended when using an overhead door closer (A) or if installed in high-traffic locations.
- 4 The fourth hinge is recommended when using an overhead door closer (A) and door seals (B).

THIRD-PARTY ACCESSORIES

- Overhead door closer (A)
- Door seals (B)
- Floor-mounted door stop (C)
Install it at a distance from the hinges of at least 75 % of the sash width in the direction of the lock.

Tests carried out with softwood and fixing of the hinge with screws as per technical data sheet*

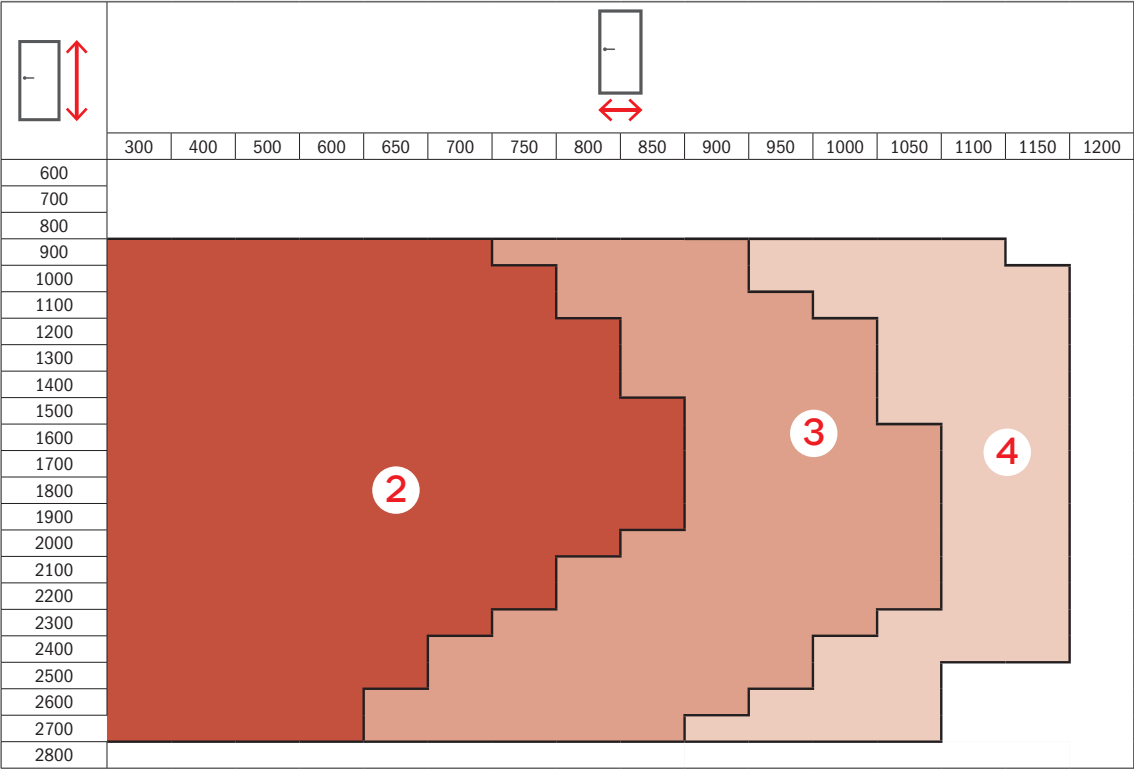

* The technical sheets are available at www.agb.it.
Doors with specific gravity of 60 kg/m².