

LIFT & SLIDE

Innovations for different situations



Open, Close, Live

ONE MARKET, MANY VARIABLES

Many variables must be considered when deciding which Lift&Slide doors and windows are to be placed on offer. Among the major variables, we note:

THE CUSTOMER NEEDS

The customer needs are undeniably fundamental for stipulating supply contracts. Maximum performance ratings are not always the main variables considered during customer decision-making. While not detracting in any way from questions relating to the minimum requirements laid down by current regulations, we note that, in very many cases, other parameters may prevail, such as improved accessibility, economic savings etc.

WHERE WINDOWS AND DOORS ARE INSTALLED

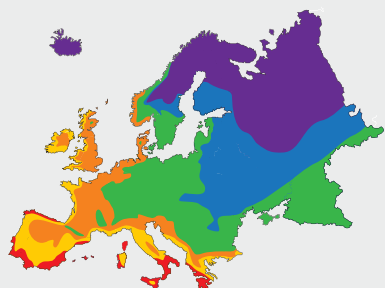

Climate zones determine the characteristics of windows and doors in compliance with the regulations.

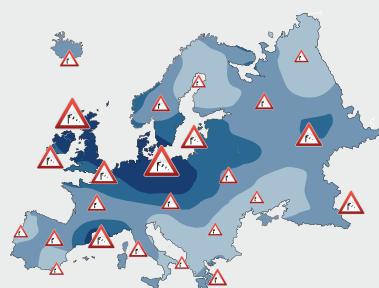

Assessing the wind zone in which windows and doors have to be installed is equally important; this factor is particularly important with regard to resistance against air, water and wind.

TPOLOGY OF BUILDING

The value relative to façade or frontage noise abatement, as established by regulations, varies as a function of the use to which the building will be used. It goes without saying that noise abatement values are particularly important for Lift&Slide windows and doors, i.e. for windows and doors which generally account for much of a building's frontage.

Habitats



School



Hospital



Office



Home

noise abatement

48 D_{2m,nT,w}

45 D_{2m,nT,w}

42 D_{2m,nT,w}

40 D_{2m,nT,w}

A RANGE OF SOLUTIONS FOR LIFT&SLIDE DOORS AND WINDOWS

Should we focus on designing a specific Lift&Slide assembly with excellent performance? Within a market in which suppliers of windows and doors must meet the needs of various customers, any attempt to adopt a single solution, perhaps with an excellent performance rating, while also meeting legal obligations and remaining competitive, would constitute an excessively demanding task.

INNOVATIONS FOR DIFFERENT SITUATIONS

Many versions are available with progressively higher performance ratings (all are rateable above the standards and regulatory requisites).

Climatech **Uni-V** 68 - 78/80 - 92 mm
Climatech **Easy** 68 - 78/80 - 92 mm
Climatech **Wood-Aluminium + Uni-V + Easy**
Climatech **HS Zero** + **Uni-V HS Zero**
Climatech **IMAGO** 68 - 78 - 92 mm + **Uni-V**



water = up to **9A**

air = up to **4**

wind = up to **C3**

impact = up to **5**

noise abatement (dB) = up to **41** with glass **43**

heat transmittance (W/m²K) Climatech 68 = up to **0,90** with glass **0,70**
heat transmittance (W/m²K) Climatech 78/80 = up to **0,79** with glass **0,60**
heat transmittance (W/m²K) Climatech 92 = up to **0,69** with glass **0,50**

Intermediate 68 mm + **Uni-V** 68 mm + **Easy** 68 mm



water = up to **7A**

air = up to **4**

wind = up to **A4 - C2**

impact = up to **5**

noise abatement (dB) = up to **40** with glass **43**

heat transmittance (W/m²K) = up to **0,92** with glass **0,70**

CONSTRUCTION PROCESSES

REMAIN THE SAME

Producers need not revolutionize the methods of construction they have always used.

However, they must strictly abide by the indications provided in the production, assembly and installation specifications. These specifications are the outcome of a laborious and time-consuming process of research and development.



USING THE MILLING CUTTER YOU ALWAYS USE!

The mouldings of the profiles of sashes and frames are produced with just one milling cutter - the one you always use! In practical terms, this means that you needn't to invest in new milling cutters (immediately saving in money).



Basic 68 - 78/80 - 92 + Uni-V 68 - 78/80 - 92 mm



- water = up to **4A**
- air = up to **4**
- wind = up to **C2**
- impact = up to **5**
- noise abatement (dB) = up to **41** with glass **43**
- heat transmittance (W/m²K) **Basic 68** = up to **0,86** with glass **0,70**
- heat transmittance (W/m²K) **Basic 78/80** = up to **0,79** with glass **0,60**
- heat transmittance (W/m²K) **Basic 92** = up to **0,69** with glass **0,50**

L&S vanishing



- water = up to **7A**
- air = up to **4**
- wind = up to **C1**
- impact = up to **2**
- heat transmittance (W/m²K) = up to **0,96** with glass **0,70**

LIFT&SLIDE RANGE



Climatech **Uni-V** 68 - 78/80 - 92 mm 4
Climatech **Easy** 68 - 78/80 - 92 mm

IMAGO 68 - 78 - 92 mm + **Uni-V** 7

Climatech **Wood-Aluminium** + **Uni-V** + **Easy** + **HS Zero** 8



Intermediate 68 mm + **Easy** 68 mm + **Uni-V** 68 mm 9



Basic 68 - 78/80 - 92 mm + **Uni-V** 68 - 78/80 - 92 mm 12



L&S vanishing 14



Layouts A/E - B/F
certified

Climatech

Uni-V 68 - 78/80 - 92 mm + Easy

IN OTHER WORDS, EXCELLENCE

The new Climatech project is the outcome of in-depth study and lab-and field-testing activities, enabling standards which were once totally beyond the reach of Lift&Slide doors and windows. Very high thermal performance ratings. Accessories for the three types (68, 78/80 and 92 mm).



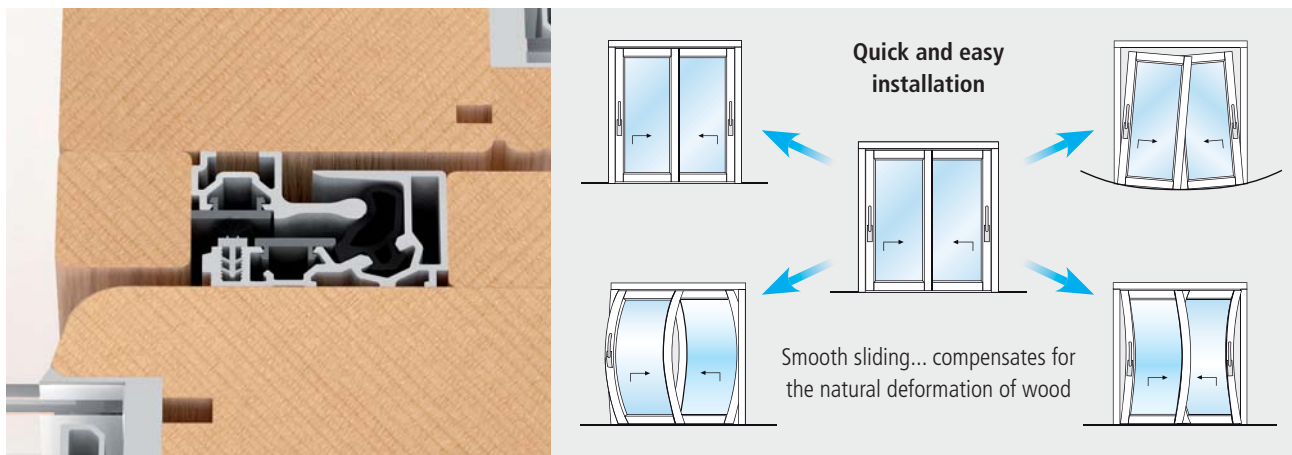

● Uni-V central point

The new Uni-V central point offers wide milling tolerances, compensates for the natural deformation of wood and removes the after-sales works on site linked to the Lift&Slide disease.

Thanks to this revolutionary central point, there is no contact between the sash and the frame. The result is a fluid and silent opening movement.

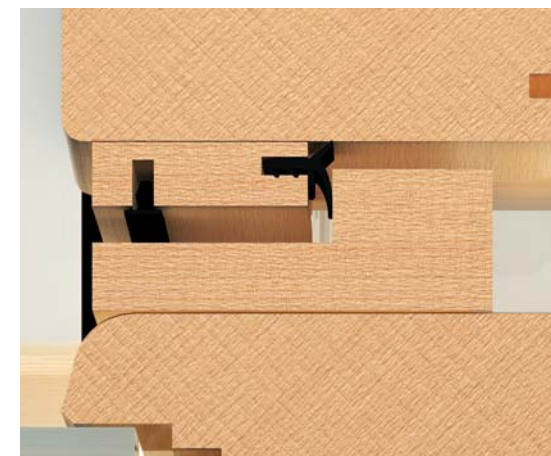

● Easy central point

The Easy version, completely made of wood, offers a more appreciated solution from the aesthetic point of view, maintaining the area perfectly insulated.

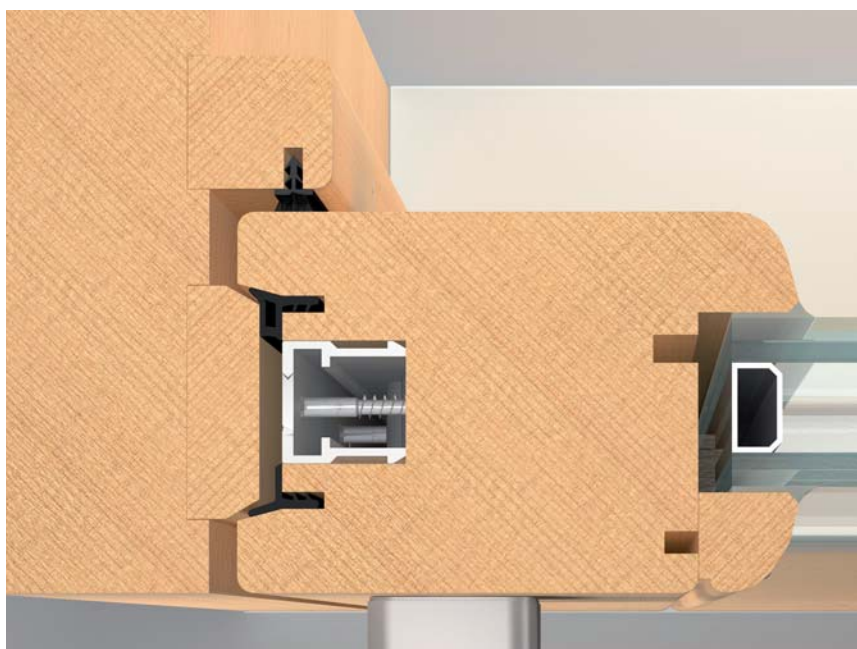

● Decompression chamber

This accessory is related to Climatch, Intermediate and Basic versions. This profile allows to create a decompression chamber outside the side point, providing a barrier against water, air and low temperatures, without special milling cutters.



● Gaskets (heat-sealed)

The gaskets, positioned on the perimeter of the moving sash, are a vitally important factor in raising the performance ratings of windows and doors. The outer gasket, with its special form, enables sealing of the sash with the threshold.



● Central point pad

This is positioned between central profile and the threshold. Thanks to its special shape, optimal water flow is enabled, as well as perfect connection with the profile itself. Furthermore, it contributes significantly to heat insulation of the central point.

● Top sealing profile

This is an innovative insulation system. It consists in a profile running along the top rail of the sash and resting on the listel. The sash and frame are therefore sealed thanks to this profile, featuring closed cells foam rubber.



● Climatech fibreglass-reinforced threshold

This new fibreglass-reinforced composite-material threshold ensures optimal strength and excellent heat insulation. The finish ensures optimal scratch- resistance.



IMAGO

68 - 78 - 92 mm + Uni-V

Layouts A/E
certified



Imago is the first Lift&Slide door completely in wood selected by the ADI Design Index to compete for the Compasso d'Oro.

LIVE OUTSIDE THE BOX

Less visible frame, more space to the image. With the quality of the performances by AGB. Imago is the innovative hardware system which allows to realize the Lift&Slide for wood with a frame depth less than 2 cm. Imago gives to the landscape the main role. Thanks to the minimal design, it extends the space and blends the internal places with the external environment. It expands the possibilities and the design solutions. Imago guarantees thermal insulation, resistance against atmospheric agents and anti-burglar security thanks to the integration of the Climatch threshold, the dedicated range of innovative accessories and the Poseidon security lock.

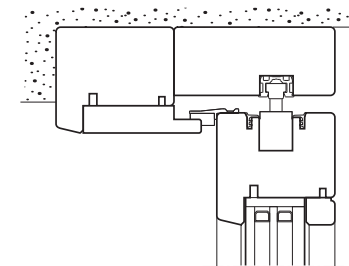

Wood and image only: the hardware disappears on the frame

The sliding top guide has been inserted into the frame to hide every functional element.

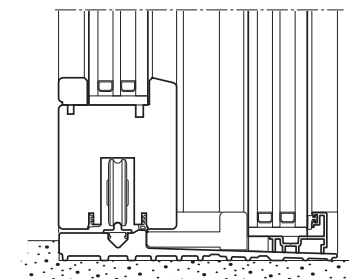

Leaving space to the glass: a room without bounds

The lower transom of the fixed sash has been eliminated. The glass and the external environment become the centre of the room. A thin aluminium profile creates the glass seat.

DISCOVER MORE



www.imago.agb.it



Layouts A/E - B/F
certified

Climatech

Wood-Aluminium Uni-V + Easy

Alunova
Batiment - Twin System
Europrofil

Gutmann
Torresan Profili
Uniform



● Easy central point

Made with wooden listels, thanks to the retaining gasket and the brush, reaches high standards in insulation, maintaining the nice design of the door.

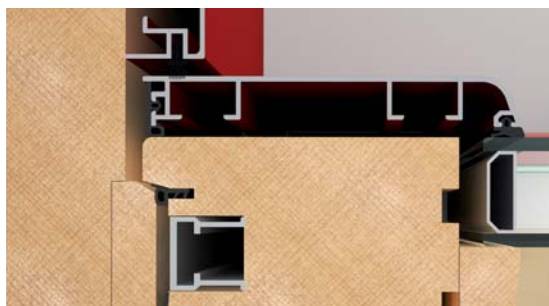

● Lock side point

The brush applied on the aluminium profile, creates a decompression chamber on the outside of the side point, creating the first barrier against water, air and cold.

PERFORMANCE & STYLE

Climatech repeats the performances on the Wood-Aluminium version, fusion of design and functionality. The innovative central points Uni-V and Easy and the decompression chamber on the lock side make an efficient barrier against atmospheric agents, maintaining the high aesthetic value of the door. Suitable with the more widespread Wood-Aluminium profiles.

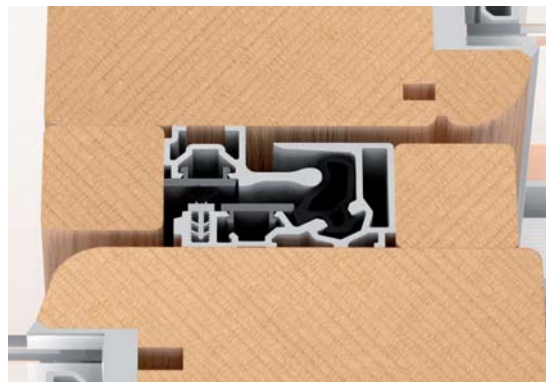

● Uni-V central point

The new Uni-V central point offers wide milling tolerances, compensates for the natural deformation of wood and removes the after-sales works on site linked to the Lift&Slide disease. Thanks to this revolutionary central point, there is no contact between the sash and the frame. The result is a fluid and silent opening movement.



● Climatech fibreglass-reinforced threshold

This new fibreglass-reinforced composite-material threshold ensures optimal strength and excellent heat insulation. The finish ensures optimal scratch-resistance.



Layouts A/E
certified

Climatech

HS Zero[™] + Uni-V HS Zero[™]

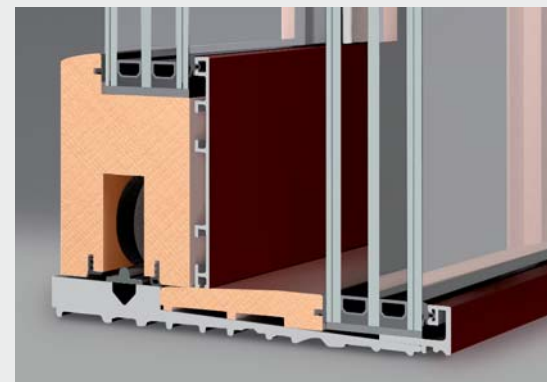

● Highlights to performances

Into the family of Climatech wood-aluminium systems comes HS Zero. The new Lift&Slide offers brightness and big visual fields, thanks to a reduced amount of space of the frame. The performances are in a very top-level: HS Zero provides the accessories range of Climatech wood-aluminium systems.



Layouts A/E - B/F
certified

Intermediate
68 mm + **Uni-V** + **Easy**

PERFORMANCE & PRICES

Optimal results for Lift&Slide doors and windows featuring aluminium thresholds with thermal brake, reduced top guide and central point with anti-burglar component which (thanks to simple but also important accessories) translates into optimal resistance classes for windows and doors. With its competitive prices and top performance ratings, this is the ideal solution for building projects involving large quantities of units.





● Central point

This is made up of an anti-burglar component which, thanks to its bulb gasket and brushes, ensures satisfactory insulation and effective protection against attempted burglary.

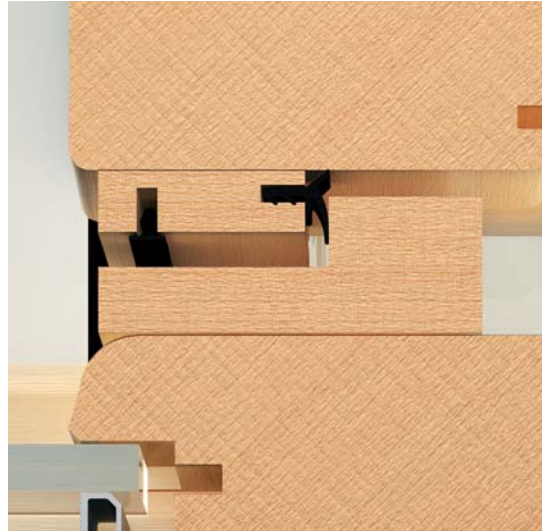

● Easy central point

An effective choice of central point. The Easy version, completely made of wood, offers a more appreciated solution from the aesthetic point of view, moreover maintaining the area perfectly insulated.

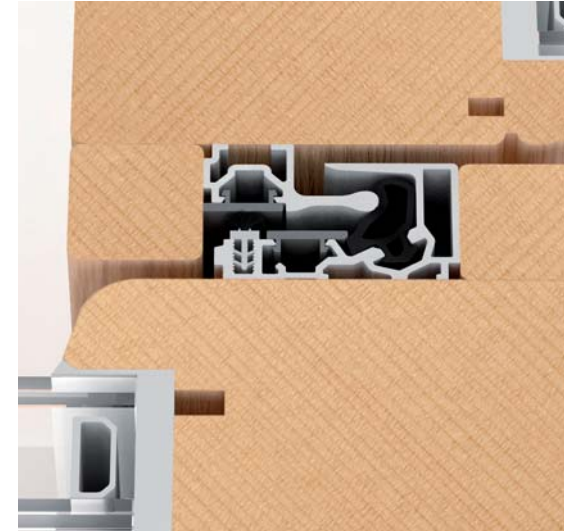

● Uni-V central point

The new Uni-V central point offers wide milling tolerances, compensates for the natural deformation of wood and removes the after-sales works on site linked to the Lift&Slide disease. Thanks to this revolutionary central point, there is no contact between the sash and the frame. The result is a fluid and silent opening movement.

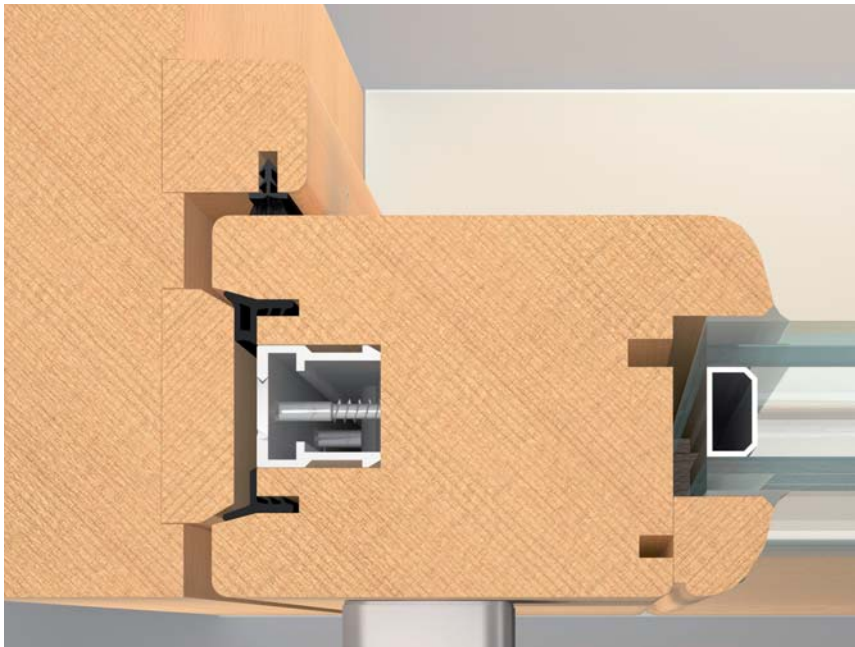

● Decompression chamber

This accessory is related to Climatech, Intermediate and Basic versions. This profile allows to create a decompression chamber outside the side point, providing a barrier against water, air and low temperatures, without special milling cutters.



● Gaskets (heat-sealed)

The gaskets, positioned on the perimeter of the moving sash, are a vitally important factor in raising the performance ratings of windows and doors. The outer gasket, with its special form, enables sealing of the sash with the threshold.



● **Top point**

This traditional coated sponge pad, combined with a reduced universal guide, ensures optimal resistance against atmospheric agents.



● **Top sealing profile**

This is an innovative insulation system. It consists in a profile running along the top rail of the sash and resting on the listel. The sash and frame are therefore sealed thanks to this profile, featuring closed cells foam rubber.



● **Central point pad**

This new rubber pad's special form ensures sealing of the central point with the threshold, thus providing an effective barrier against water infiltration.

● **Aluminium threshold with thermal brake**

This provides satisfactory heat insulation and also satisfactory water flow, due to the inclined plane on which the moving and fixed sashes rest.





Basic

68-78/80-92 mm + **Uni-V**

Layouts A/E - B/F
certified

GOOD-LOOKING & PRACTICAL

Excellent performance ratings are guaranteed for these Lift&Slide doors and windows with low tracks, reduced top guide and central point with wooden gasket-bearing strip. Even the cheapest and most traditional Lift&Slide doors and windows provide performance ratings which enable their use in a broad range of situations. This solution is indicated when windows and door accessibility must be improved or when the principal requires a low track for aesthetic effect.



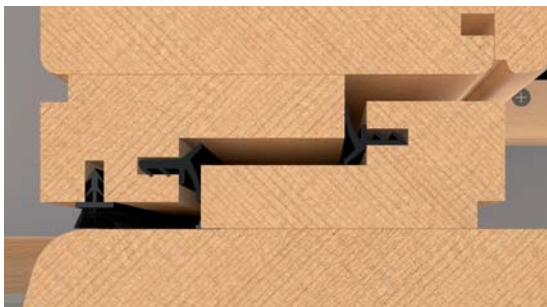

● Central point

This is constructed with traditional wooden gasket-bearing strips. A simple brush is added to the outer profile, creating a depression chamber and easing the burden on the gaskets, with regard to protection from water and air.

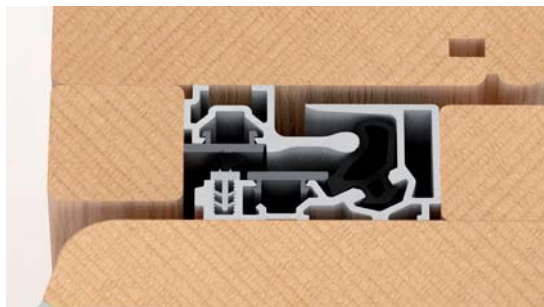

● Uni-V central point

The new Uni-V central point offers wide milling tolerances, compensates for the natural deformation of wood and removes the after-sales works on site linked to the Lift&Slide disease. Thanks to this revolutionary central point, there is no contact between the sash and the frame. The result is a fluid and silent opening movement.



● Decompression chamber

This accessory is related to Climatech, Intermediate and Basic versions.

This profile allows to create a decomposition chamber outside the side point, providing a barrier against water, air and low temperatures, without special milling cutters.

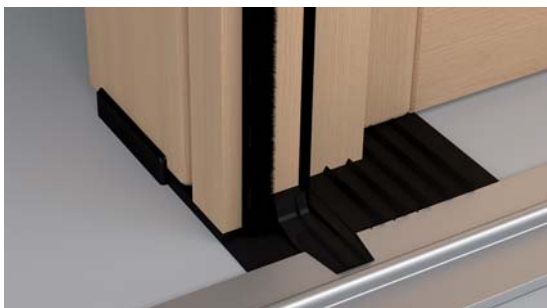

● Central point pad

This rubber strip seals the central point with the threshold, thanks to its special form. It therefore provides an effective barrier against water infiltration.



● Low track

Through synergic action with the new gaskets, and with the central pad, the low tracks also present optimal water-resistance performance ratings. However, the flat floor is not conducive to water flow. Hence windows and doors are incapable of reaching resistance classes of more than 4A. This system enables construction of specific accessories for certifiable sliding doors with compartment.

● Gaskets (heat-sealed)

The gaskets, positioned on the perimeter of the moving sash, are a vitally important factor in raising the performance ratings of windows and doors. The outer gasket, with its special form, enables sealing of the sash with the threshold.



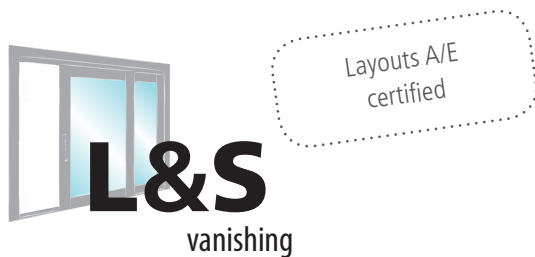

Dierre
Ermetika
Krona

Metalmeccanica Umbra
Scrigno
Eclisse

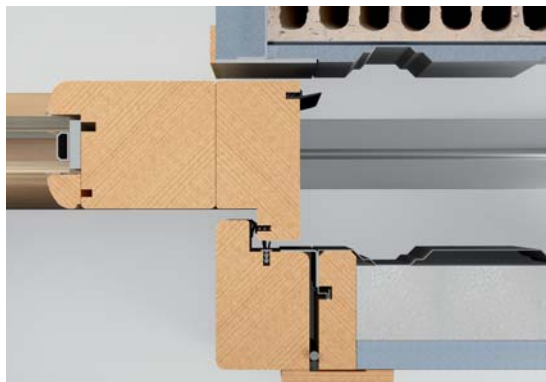

● Frame joint

Made with wooden listels, holding the gaskets. A brush is added, creating a de-compression chamber, lightening the work of the internal gaskets in order to protect from air and water penetration.

● Low track

Through the synergic action with the new gaskets, and with the central pad, the low tracks also present optimal water resistance performance ratings.

THE RESERVED SOLUTION

The project that seemed to be impossible to certificate against atmospheric agents, has become reality. High performances on waterproof, air-proof, and heat transmittance rate, compatible with all severe protocols for energy efficient buildings.



● Top point

A classic coated sponge pad, combined with a reduced universal guide, ensures optimal resistance against atmospheric agents. It is possible to use the innovative top sealing profile, running along the top rail of the sash and resting on the listel. The sash and the frame are therefore sealed thanks to this profile, featuring closed cells foam rubber.



AGB CASCADING: ONE PROBLEM LESS!

For CE marking of Lift&Slide doors and windows, while also bearing in mind the indications provided by current regulations, AGB foresees application of a cascading contract for the Climatch, Intermediate and Basic versions, for the purposes of issue of ITT trial results obtained with the samples tested by AGB.

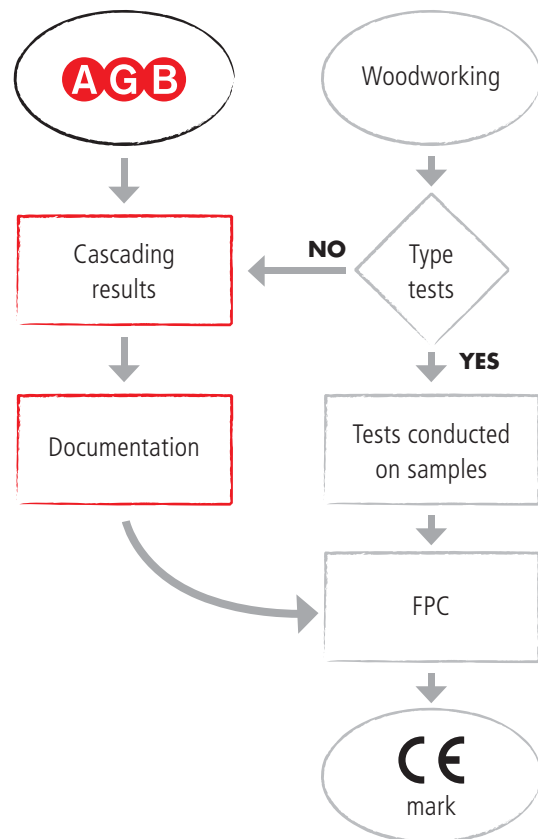

CASCADING TAKEN SERIOUSLY

Cascading is an opportunity. It is not a pretext for avoiding type tests. AGB is therefore committed to providing all the information and documentation required to enable suppliers to produce windows and doors which conform to the tested item. Suppliers thus become the fully authorised recipients of the test results. To this end, AGB provides the following documentation:



AGB KNOW-HOW

AGB's in-depth research, conducted over a long period of time, has led to the development of new components capable of enhancing the performance ratings of windows and doors while also allowing us to gain extensive knowledge of all the critical points of these items. This know-how is transmitted to suppliers of windows and doors (cascade mode). This practice, in turn, raises standards for Lift&Slide doors and windows.

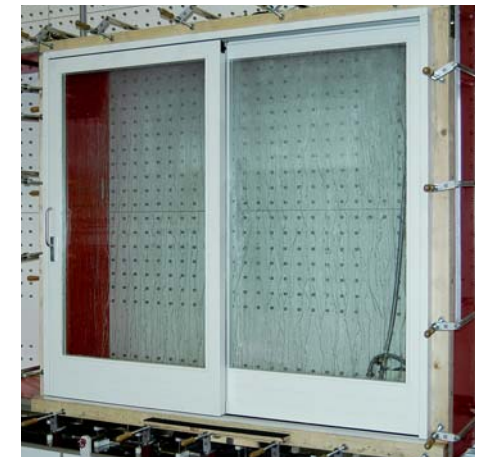

Climatch Lift&Slide door and window during water resistance test.

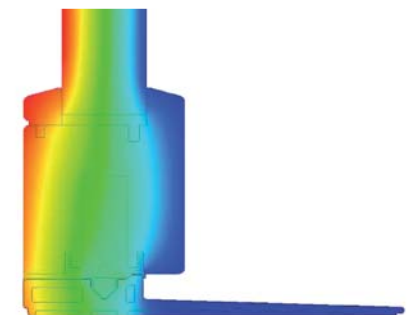

Calculation of heat transmittance coefficient for Climatch Lift&Slide door and window.



Alban Giacomo spa

Via A. De Gasperi, 75
36060 Romano d'Ezzelino (VI Italy)
+39 0424 832 832
www.agb.it - www.imago.agb.it
info@agb.it