

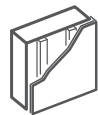

ECLIPSE 4.1

For flush doors
in wood paneling



Ideal for applications with
drywall and overlapping
frame architraves



Up to 70 kg
of loading capacity
with two hinges



Unchanged handle height
even turning the sash
on vertical axis



44 mm sash
thickness



For wood and
aluminium doors



Flush
covers

MADE IN ITALY

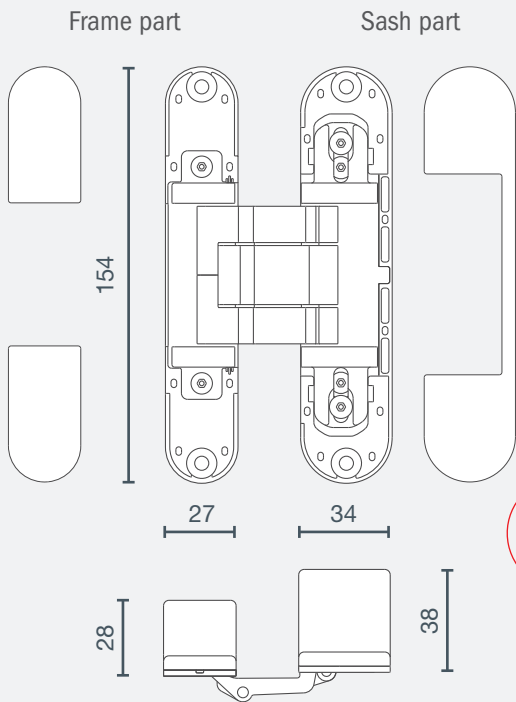

Adjustments

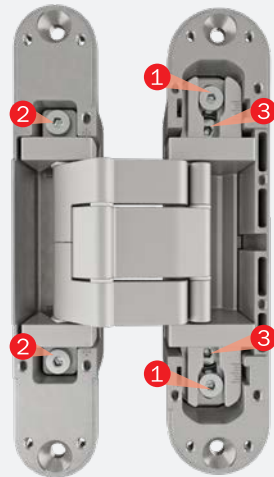

- Pressure: ± 1 mm 1
- Vertical: ± 3 mm 2
- Horizontal: $+3/-2$ mm 3

Milling layout

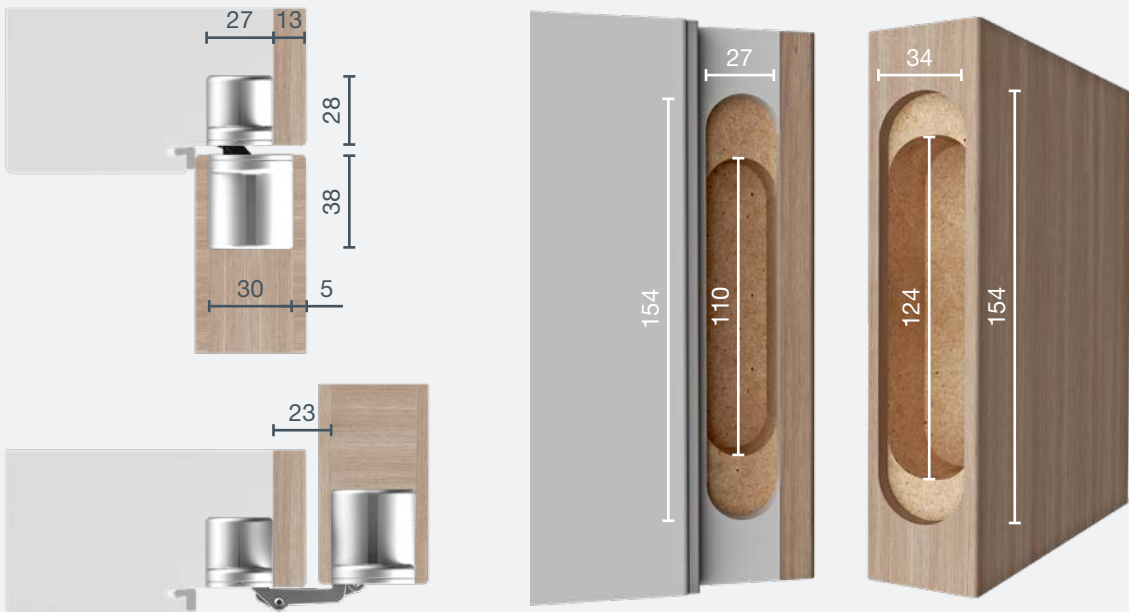

Finishes

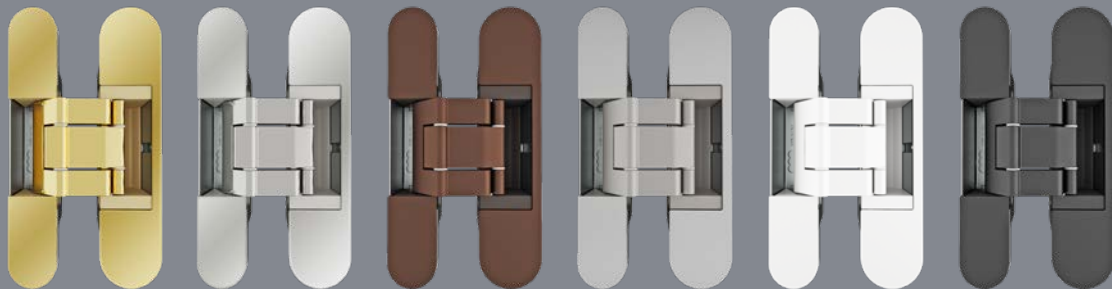

03. Enamelled brass plated / 06. Nickel plated / 22. Enamelled bronze plated / 34. Matt chromium plated / 91. White / 93. Matt black